

NEW BUILDING: NEW LOCATION

Upper Floor

LEGEND

- CLUB ROOM / CULTURAL PROGRAM / MODEL RAILROAD CLUB ROOM
- KITCHENETTE
- GROUP EXERCISE
- FITNESS
- GYM
- LOBBY, BREAK OUT SPACE, CIRCULATION
- ADMINISTRATION
- MECHANICAL / STORAGE
- RESTROOMS / LOCKERS
- ROOFTOP GARDEN
- MAIN ENTRANCE

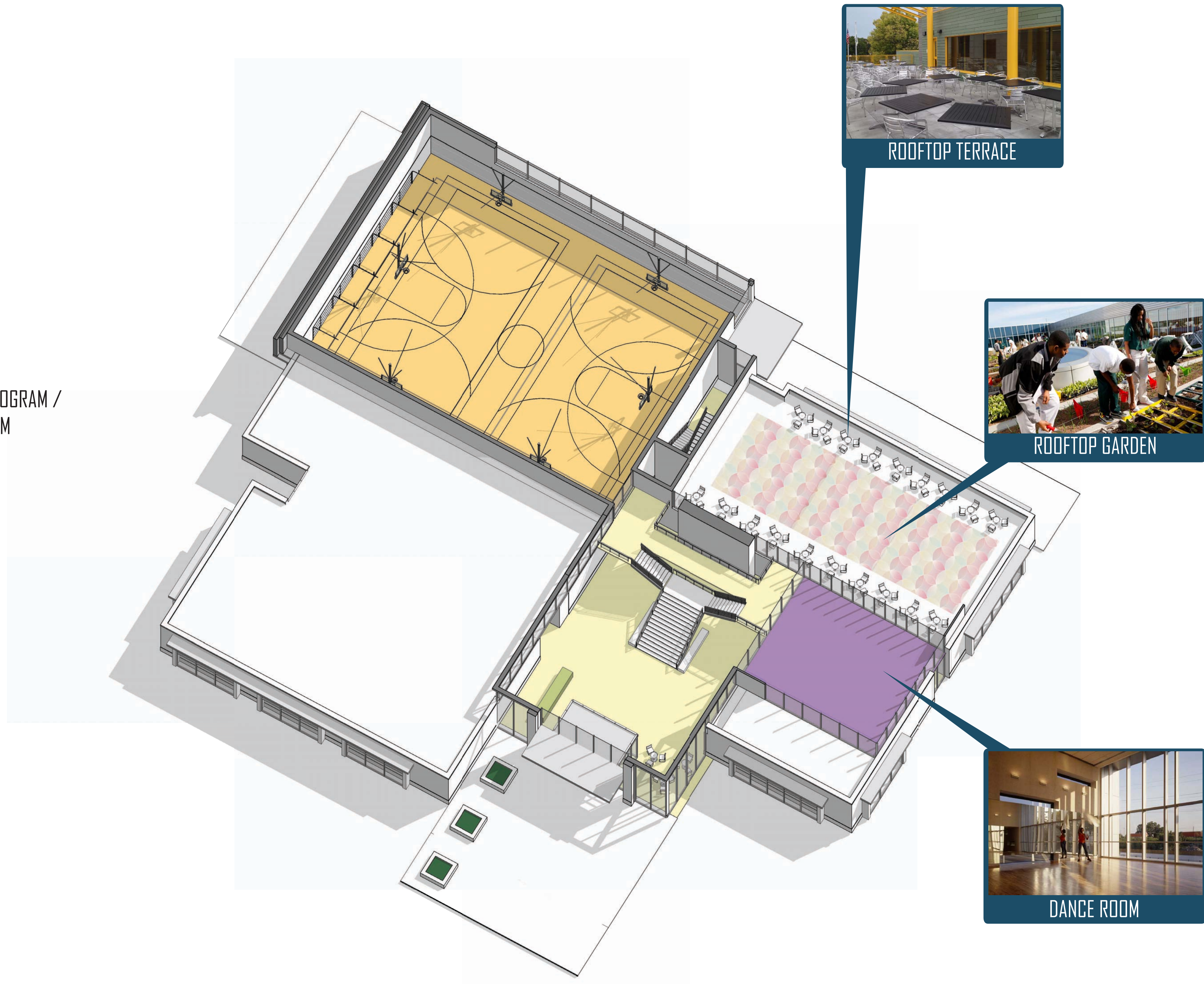

Ground Floor

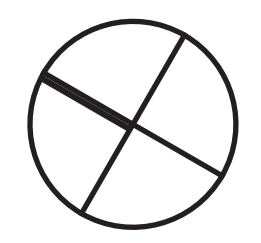
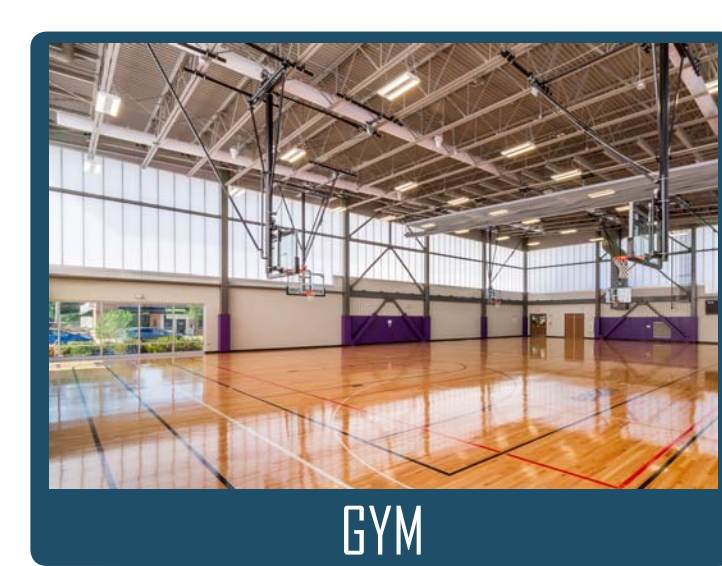
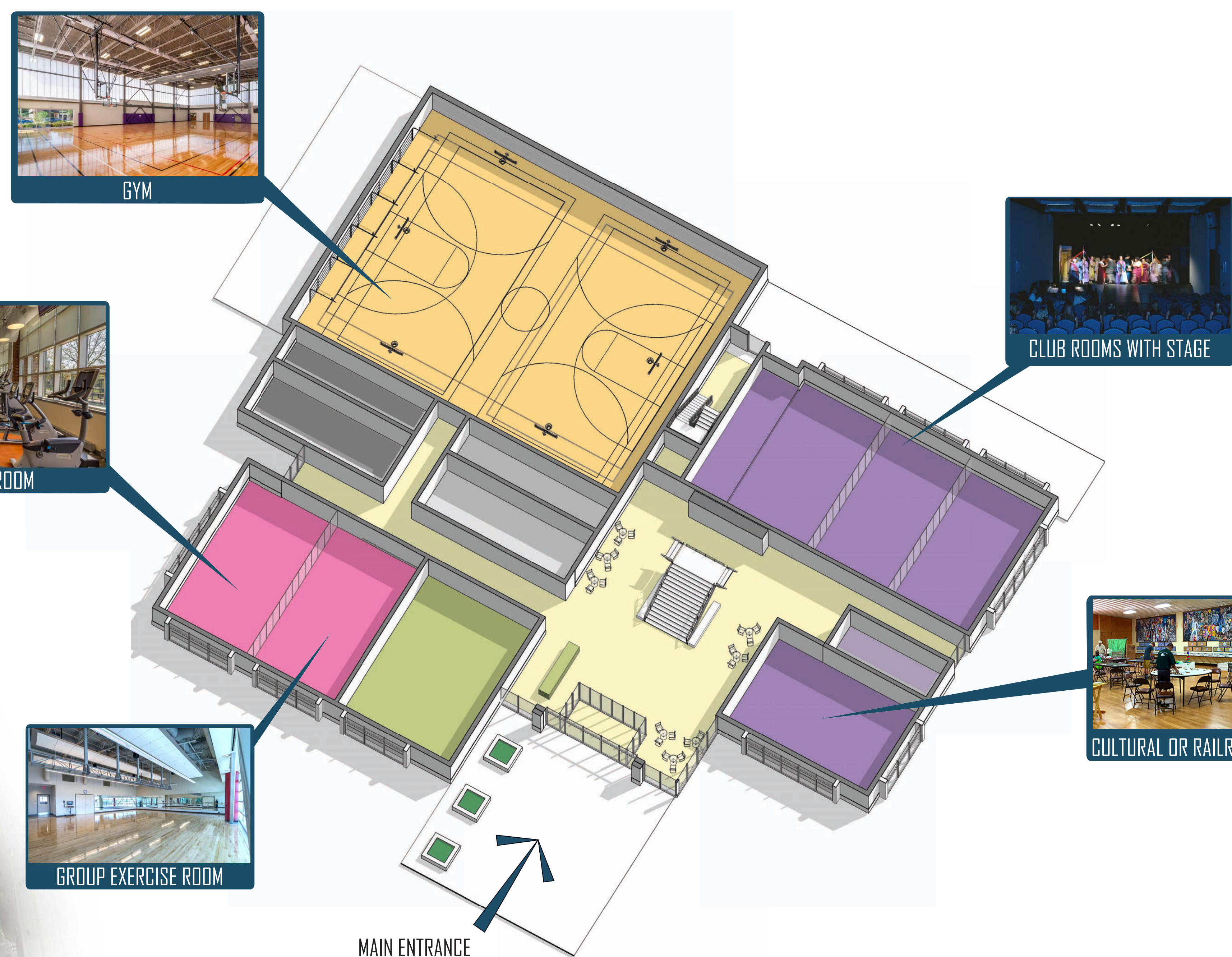

27,000 SF
\$22,000,000

*Existing fieldhouse to remain open during construction.
*Disclaimer: cost estimates based on current probable 2019 construction cost in IL.

CLARENDON COMMUNITY CENTER PARK